

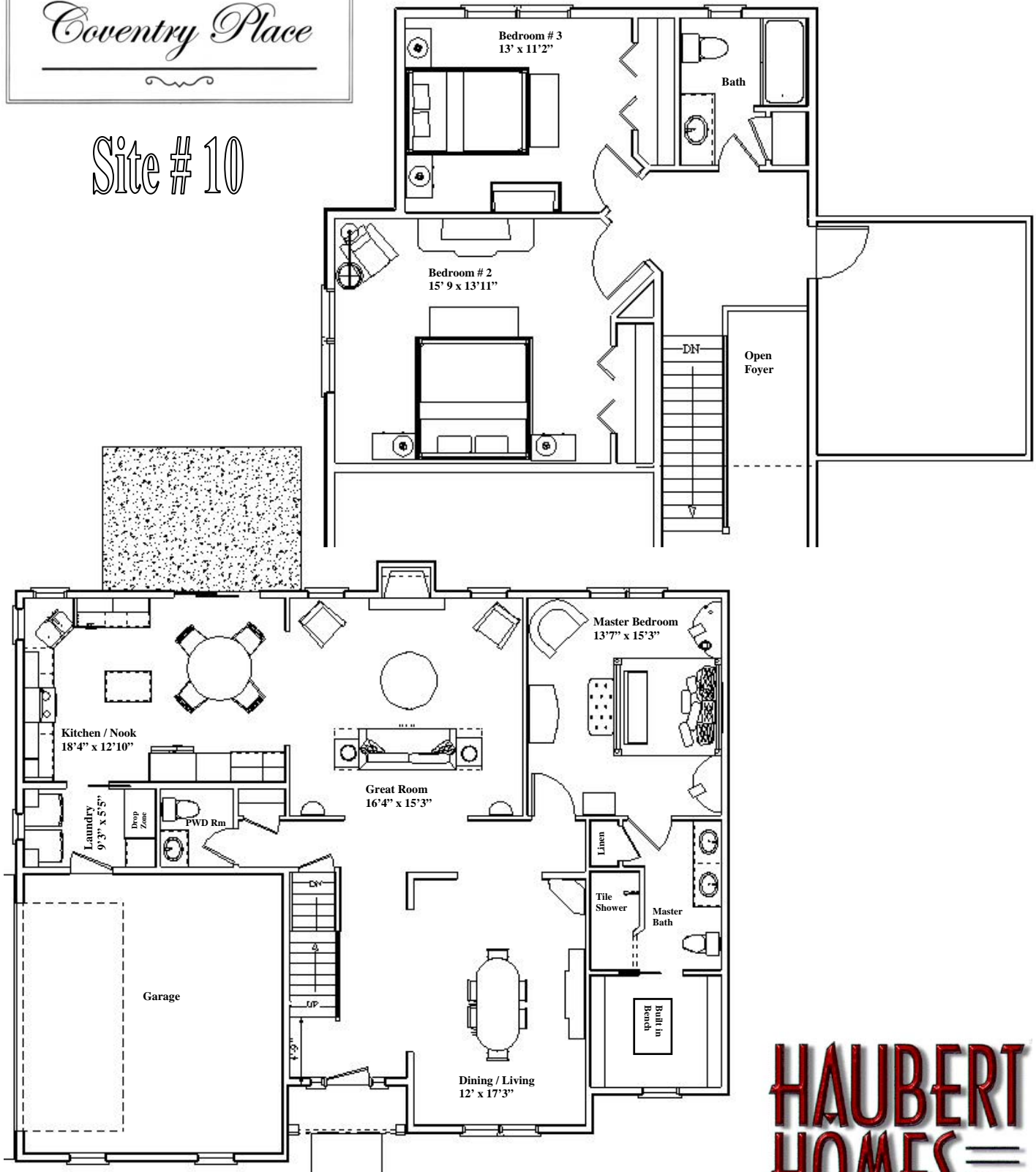

Site # 10

Cambridge



Directions: From State College, Take 322/220 West to the Toftrees Exit. At the top of the ramp, turn left onto Waddle Road. Go about 1/2 mile to the red light at Clearview Ave. Turn left onto Clearview and go to stop sign, Turn right onto North Allen Street. The home will be on the corner, Site #10 in Coventry Place.

**HAUBERT
HOMES** Inc.
Custom Building For Generations



**Make 1772 North Allen St
Your New Address
Only \$318,860**



- **Easy Living! No Mowing, Weeding or Shoveling**
- **Single Family Condominium**
- **2134 Sq Ft Cambridge Two Story w/ Two Car Garage**
- **Impressive Curb Appeal w/ Stone Front**
- **9' Ceilings on First Level**
- **Open Foyer w/ 3/4" Hardwood Flooring**
- **Oak Staircase & Railing**
- **Massive 12' x 17'4" Dining / Living Room**
- **Spacious Great Room w/Gas Fireplace**
- **Large Country Kitchen / Nook w/ Ceramic Tile Flooring**
- **Wellborn Bedford Sq Poplar Kitchen Cabinets Featuring:
Built-in Pantry, Desk Area, Pot & Pan Storage, Cookie
Sheet, & Waste Cabinets**
- **LG Hi-Mac Solid Surface Kitchen Counter Tops
w/ Under Mount Sink & Moen Faucet**
- **GE Appliance Package :**
**Range w/ Microwave Over, Dishwasher,
Refrigerator & Garbage Disposal**
- **First Floor Master Suite / Bath Featuring:
Ceiling Fan, Huge Walk-in Closet, Double
Bowl Vanity, Custom Walk-in Ceramic Tile
Shower & Ceramic Tile Flooring**
- **First Floor Laundry w/ Ceramic Tile Flooring**
- **Convenient Drop Zone in Laundry**
- **Powder Room w/ 3/4" Oak Flooring**
- **Hardwood Flooring in Upstairs Hall**
- **Two Spacious Quest Quarters Upstairs**
- **Full Bath Upstairs w/ Ceramic Tile Flooring**
- **Deluxe Mohawk Carpeting**
- **Deluxe Light Package**
- **Exterior Post Lamp**
- **Lots of Phone & TV Jacks**
- **2 Exterior Hose & Electrical Outlets**
- **30 Architectural Shingles**
- **Andersen Tilt Windows w/ Screens & Grills**
- **6/0 x 6/8 Patio Door w/ Transom Leading to Patio**
- **140 Sq Ft Rear Concrete Patio**
- **12' x 14' Unfinished Attic Storage Area**
- **8' 2" Superior Foundation (1500 SF of Possibilities)**
- **Under Slab Venting**
- **Gas Heat w/ Central Air**
- **Energy Efficient Super Seal Package**
- **Professionally Landscaped**
- **Lawn Maintenance Included**
- **Paved Driveway & Front Concrete Sidewalk**

**Haubert Homes Inc, 1356 South Atherton St, Southwood Office Centre, State College, Pa 16801
Phone: 814-867-3262 Cell: 717-363-0744 Email: dbooher@hauberthomes.com**

**HAUBERT
HOMES** INC.
Custom Building For Generations